

LZCK310-10

RESIN CAST WINDOW TYPE CURRENT TRANSFORMER SPLIT CORE 400/5A

The Model LZCK310-10 is a window type resin casting split core current transformer. Some clients also called it as TTCC. This model can be used both for measurement and microcomputer protection of electrical equipment in 11KV and 35KV AC power system such as ABB-Safe Ring/Safe Plus...and cable distribution boxes.

We used imported silicon material and using our mature advanced producing technology we make sure our transformer has very good linear and more than 20 years using life in order to be qualified with all the jobs. These semicircular ring core and secondary windings are vacuum poured by insulated resin. Ratio from 300/5A to 1000/5A can be customized for user system.

All of our split core current transformers are strictly comply IEC60044-1, IEC 61869-2, ANSI/IEEE C57.13, NTC 2205, GB1208-2006, GB/T 20840.1-2010, GB/T 20840.2-2014, GB/T 22071.1-2018.

Features

1. Easily installation;
2. Size: $\phi 50 \times \phi 110 \times 32$;
3. Economic type deign;
4. High precision 0.5%, 1%;
5. Using life more than 20 years;
6. Measurement range 0-1000A AC;
7. Holding wire diameter: $\phi 50 \text{mm}$;
8. Easily installation with electricity;
9. High quality silicon steel material;
10. High magnetic conductivity silicon steel material;
11. 300/5A, 400/5A, 500/5A, 600/5A, 750/5A, 800/5A, 1000/5A;
12. 300/1A, 400/1A, 500/1A, 600/1A, 750/1A, 800/1A, 1000/1A;
13. Secondary windings are vacuum poured by polyurethane resin cast;
14. IEC60044-1, IEC 61869-2, ANSI/IEEE C57.13 , NTC 2205, GB1208-2006, GB/T 20840.1-2010, GB/T 20840.2-2014, GB/T 22071.1-2018;



Applications

1. Energy meter;
2. Power Meter;
3. Meter tester;
4. MV switchgears;
5. Electrical cabinet;
6. Load monitoring;
7. Metering device;
8. Distribution boxes;
9. Ring network cabinet;
10. Power Quality meter;
11. Low voltage metering system;
12. Distribution transformer power monitor system;

Outline drawing

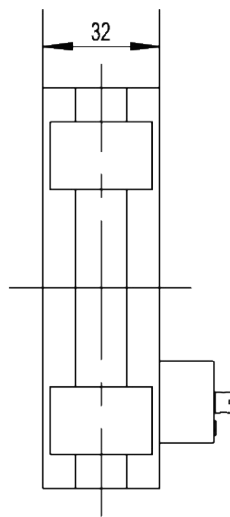
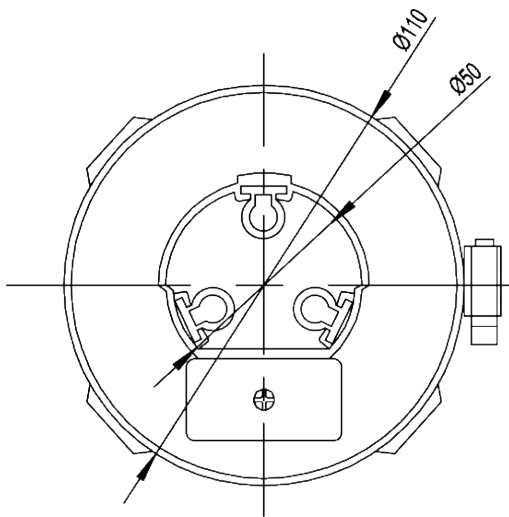

Wiring Diagrams

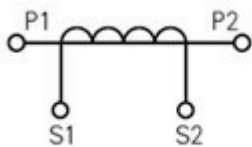

Single winding

P1, P2 is primary polarity terminal, S1, S2 is secondary polarity terminal.

P2, S2 is homonymous terminals (subtractive polarity).

Parameters

Technical parameters	
Standards	IEC60044-1; IEC 61869-2; NTC 2205; ANSI/IEEE C57.13; GB1208-2006; GB/T 20840.1-2010, GB/T 20840.2-2014, GB/T 22071.1-2018
Accuracy Class	0.5%, 1%, 3%
Range of primary rated current	300-1000A
Range of Rated load	≤10VA
Rated frequency	50/60Hz
Rated secondary current	5A, 1A
Rated short-time thermal current	40kA, 1S
Rated continuous thermal current	120%I _n
Secondary winding power frequency withstand voltage	3kV, 1min
Safety Factor Rating	(FS) <10
Safety	CAT IV 600V IEC/EN 61010-1
Insulation Class	E
Material	Polyurethane+Silicon steel sheets+Enameled wire+ABS
Mechanical parameters	
Dimensions (W×D×H) (mm)	φ50xφ110x32
Jaw cable diameter(mm)	45
Weight (kg)	1
Color	Red+black
Working conditions	
Operating temperature	-40°C to +70°C
Storage temperature	-40°C to +70°C
Outdoors Protection	Silicone sleeve optional
Environment	outdoors or indoors
Altitude	<3500 meters
Conditions	No existence of severely begrimed, erosive and radioactive gas in the air. Permission of long-term operation under rated current.

Specification

Type	LZCK310-10		
Purpose	Measuring current transformer		
Ratio	Accuracy class and rated load(VA)		
I_1/I_2	0.5	1	3
300/1	2.5	2.5	5
400/1	2.5	5	7.5
500/1	5	5	7.5
600/1	5	7.5	10
750/1	5	7.5	10
800/1	10	10	15
1000/1	10	10	15
300/5	2.5	5	7.5
400/5	5	5	7.5
500/5	5	7.5	10
600/5	5	7.5	10
750/5	10	10	15
800/5	10	10	15
1000/5	10	10	15

Selection Guide

Model	Primary rated current	Rated load	Aperture (mm)	Description (mm)	Weight (kg)
LZCK310-10	300-1000A	≤10VA	φ50	φ50 x φ110 x 32	1
LZCK322-10	30-1000A	≤15VA	φ50	φ50 x φ110 x 52	1.6
LZCK350-10	30-1000A	≤25VA	φ50	φ50 x φ110 x 105	3.1
LZCK720-10	30-1000A	≤25VA	φ80	φ80 x φ110 x 50	2.1
LZCK2500-10	30-3000A	≤30VA	φ120 , 140 , 160	φ120 x φ185 x 100	7
LZCG530-10	30-1000A	≤20VA	φ45	φ45 x φ120 x 65	2.1
LZCG930-10	30-1500A	≤25VA	φ60	φ60 x φ155 x 60	3.6
LZCT722-10	30-1500A	≤10VA	φ82	φ82 x φ130 x 55	2.3
LZCG2500-10	30-3000A	≤30VA	φ120 , 140 , 160	φ120 x φ185 x 100	7