

LZCK2500-10

50/5A SPLIT CORE 5P20 ZCT ZERO SEQUENCE PROTECTION CURRENT TRANSFORMER

The Model LZCK2500-10 zero sequence ct is a ring type resin casting split core current transformer. This model can be used both for measurement and microcomputer protection of electrical equipment in 11KV and 35KV AC power system of ring network switchgears such as ABB-Safe Ring/Safe Plus...and cable distribution boxes.

We used imported silicon material and using our mature advanced producing technology we make sure our transformer has very good linear and more than 20 years using life in order to be qualified with all the jobs. The semicircular ring core and secondary windings are vacuum poured by insulated resin.

The grounding zero sequence current protection installed on transformers in high current grounding systems serves as a backup protection for the main protection of transformers and for adjacent component grounding short circuits.

Under normal circumstances, the zero sequence current protection does not operate. When a ground short circuit occurs, the zero sequence current occurs. When it exceeds the operating current of the protection, the current relay K_A acts. After a delay of t_K , the circuit breakers on both sides of the transformer are tripped. The operating current of the zero sequence current protection should be greater than the operating current of the backup section of the zero sequence current protection for the outgoing line on that side. The action time limit for protection is also one greater than the latter δT . All of our GFUVE zero sequence current transformers are strictly comply IEC60044-1, IEC 61869-2, ANSI/IEEE C57.13, GB1208-2006, GB/T 20840.1-2010, GB/T20840.2-2014, GB/T 22071.1-2018, IEC/EN61010-2-032, IEC/EN 61010-2-031.

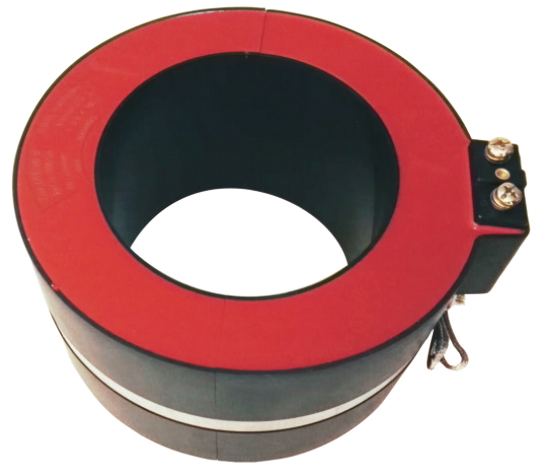

Features

1. Meter tester;
2. Energy meter;
3. Power Meter;
4. MV switchgears;
5. Air switch cabinet;
6. Distribution boxes;
7. Power Quality meter;
8. Ring network cabinet;
9. Measuring instrument;
10. Protective relay device;
11. Current load monitoring;
12. Low voltage metering system;
13. Three phase power transformer;
14. Medium voltage metering system;
15. Distribution Power transformer monitor system;

Features

1. Accuracy class 0.5s, 0.5%, 1 ;
2. Protection class 5P20, 5P10, 10P15, 10P10, 10P5;
3. IEC60044-1, IEC/EN 61869-2, NTC 2205, GB/T 20840.2-2014, ANSI/IEEE C57.13;
4. Measurement range 0-2000A AC;
5. Holding wire diameter: $\phi 120\text{mm}$, $\phi 140\text{mm}$, $\phi 160\text{mm}$;
6. Size: $\phi 120 \times \phi 185 \times 100$, $\phi 140 \times \phi 210 \times 100$, $\phi 160 \times \phi 250 \times 80$;
7. Secondary windings are vacuum poured by insulated resin;
8. As a measurement and protection current transformer;
9. High magnetic conductivity silicon steel material;
10. Using life more than 20 years;
11. Easily installation, with mounting bracket ;
12. Support Dual Ratio;
13. Polyurethane resin casting;
14. The protection level CT can accept customized design;
15. 50/5A, 100/5A, 200/5A, 300/5A, 400/5A, 500/5A, 600/5A, 800/5A, 1000/5A...;
16. 100/1A, 200/1A, 300/1A, 400/1A, 500/1A, 600/1A, 750/1A, 800/1A, 1000/1A...;

Outline Drawing

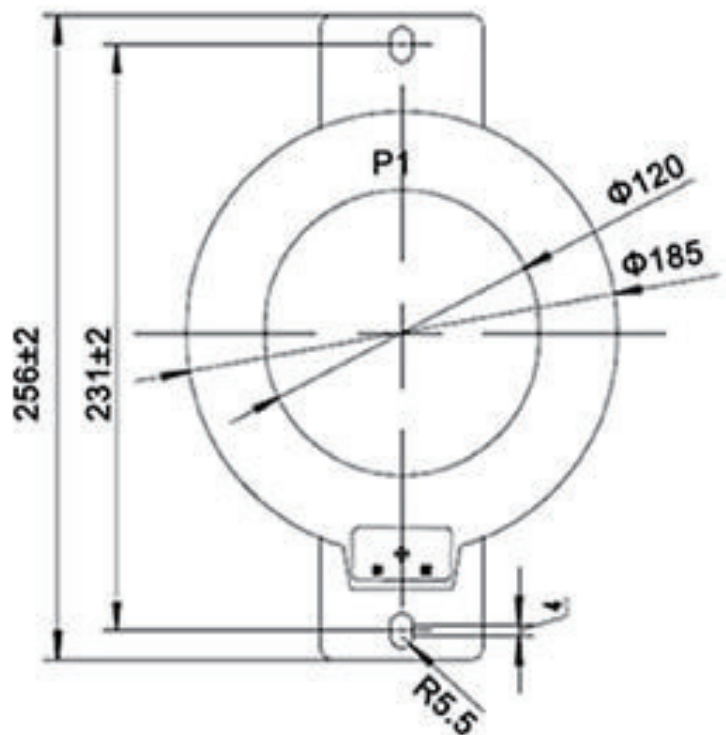
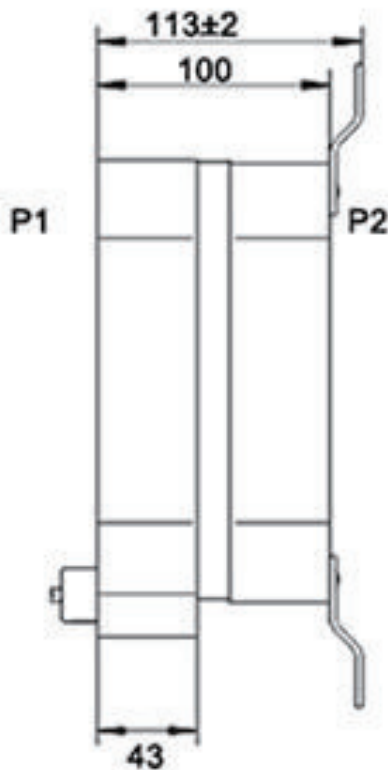

Parameters

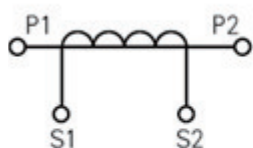

Single winding

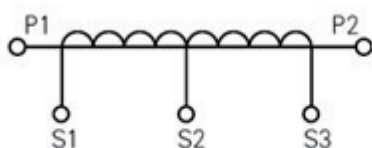

Secondary winding with tap

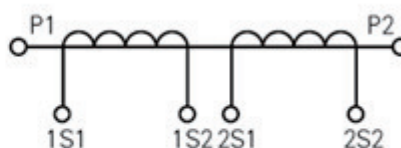

Double winding

P1, P2 is primary polarity terminal, S1, S2 is secondary polarity terminal.

P2, S2 is homonymous terminals (subtractive polarity).

Parameters

Technical parameters	
Standards	IEC60044-1; IEC 61869-2; NTC 2205; ANSI/IEEE C57.13; GB1208-2006; GB/T 20840.1-2010, GB/T 20840.2-2014, GB/T 22071.1-2018
Accuracy Class	0.5,1 (IEC61869-2 standard) 5P20, 5P10, 10P10, 10P15, 10P5
Rated primary current	50-2000A
Rated load	≤25VA
Rated frequency	50Hz or 60Hz
Rated secondary current	5A or 1A
Ratio	50/5A, 100/5A, 150/5A, 200/5A, 300/5A, 400/5A, 500/5A...2000/5A
Rated short-time thermal current	40kA, 1S
Rated continuous thermal current	120%I _n
Secondary winding power-frequency voltage	3kV, 1min
Instrument security factor	FS ≤10
Insulation Class	E
Material	Polyurethane+Silicon steel sheets+Enameled wire+ABS
Mechanical parameters	
Dimensions (W×D×H) (mm)	φ120×φ185×100, φ140×φ210×100, φ160×φ250×80
Jaw cable diameter(mm)	120, 140, 160
Weight (kg)	7, 8, 9
Operating conditions	
Operating temperature	-40°C to +70°C
Daily average temp	<+40°C
Storage temperature	-40°C to +70°C
Environment	indoors
Altitude	<3500 meters
Condition	No existence of severely begrimed, erosive and radioactive gas in the air. Permission of long-term operation under rated current.

Technical Data

Type	LZCK2500-10			LZCK2500-10			LZCK2500-10			
Purpose	Measuring current transformer			Protection current transformer			Double winding current transformer			
Ratio	Accuracy class and rated load(VA)			Accuracy class and rated load(VA)			Composite accuracy class and rated load (VA)			
I ₁ /I ₂	0.5	1	3	10P15	10P10	10P5	0.5	1	10P10	10P5
100/1	2	2.5	5	2	2.5	5	2	2.5	1.5	2
200/1	2	2.5	5	3	5	7.5	2.5	2.5	2	2
300/1	2.5	3.75	5	3	5	7.5	3.75	3.75	2.5	2.5
400/1	2.5	5	10	3	5	10	5	5	2.5	2.5
500/1	2.5	5	10	3.75	6.25	10	5	5	2.5	2.5
600/1	5	7.5	10	5	7.5	10	5	5	5	5
750/1	5	7.5	10				5	5	5	5
800/1	5	10	15				5	5	5	5
1000/1	5	10	15				5	5	5	5
50/5			2.5			2				
75/5			2.5			2.5				
100/5			2.5			2.5		2.5		2.5
200/5			2.5			5	2.5	5		2.5
300/5	5	5	5	2.5	5	7.5	5	5	2	2.5
400/5	5	5	5	2.5	5	7.5	5	7.5	2.5	5
500/5	5	7.5	10	5	7.5	10	5	7.5	2.5	5
600/5	5	7.5	10	5	7.5	10	5	10	2.5	5
750/5	7.5	10	15	5	10	10	7.5	10	2.5	5
800/5	7.5	10	15	5	10	10	7.5	15	2.5	5
1000/5	10	15	20	10	10	10	10	15	2.5	5
1200/5	10	15	20	10	10	10	10	15	2.5	5
1500/5	10	15	20	10	10	10	10	15	2.5	5
1600/5	20	25	30	10	10	10	10	15	2.5	5
2000/5	20	25	30	10	10	10	10	15	2.5	5

Selection Guide

Model	Primary rated current	Rated load	Aperture (mm)	Description (mm)	Weight (kg)
LZCK310-10	300-1000A	≤10VA	φ50	φ50 x φ110 x 32	1
LZCK322-10	30-1000A	≤10VA	φ50	φ50 x φ110 x 52	1.6
LZCK350-10	30-1000A	≤25VA	φ50	φ50 x φ110 x 105	3.1
LZCK720-10	30-1000A	≤25VA	φ80	φ80 x φ110 x 50	2.1
LZCK2500-10	30-3000A	≤30VA	φ120 , 140 , 160	φ120 x φ185 x 100	7
LZCG530-10	30-1000A	≤20VA	φ45	φ45 x φ120 x 65	2.1
LZCG930-10	30-1500A	≤25VA	φ60	φ60 x φ155 x 60	3.6
LZCT722-10	30-1500A	≤10VA	φ82	φ82 x φ130 x 55	2.3
LZCG2500-10	30-3000A	≤30VA	φ120 , 140 , 160	φ120 x φ185 x 100	7

Ordering Information

Be sure to the type, current ratio, accuracy class, rated load and use of the products when you plan to make a order. Special specifications could be customized. All kinds of different specifications and parameters current transformers can be made according to your needs.